



GRANDHUB

Inspiration comes from technology

Global Conferencing Solution Expert

Based on the corporate spirit of continuous innovation and initiatives in invention, we insist on providing interactive products that embody modern simplicity design with user-friendly experience. We are dedicated in serving our customers to transform workplaces into digital co-working spaces to foster effective communications and constructive collaborations. Our cutting-edge technologies create an intelligent platform to inspire customers' creativities beyond imaginary and establish connections beyond boundaries.

Our Mission

Our mission is to become a leading global conferencing product's vendor offering the most feature-rich and lowest total-cost-of-ownership products to end-customers with the best local support service through a professional business partnership network.

GRANDHUB

GRANDHUB is an all-in-one product integrating multiple audio-visual technologies needed in a conference room. It incorporates the functions of a projector, whiteboard, webcam and PC into one single device, whilst providing the extendibility to be compatible with various 3rd party conferencing software and office applications.

GRANDHUB helps shape and redefines next generation of digital conferencing. Customers can perform a wide array of tasks via various embedded functions to illustrate precisely and to communicate efficiently, which enhance overall productivity and effectiveness of meetings, leading to a more cooperative and united team dynamic.







Digital Whiteboard

The user-friendly interface and intelligent gesture recognition system transform Digital Whiteboard to an essential tool for everyday meetings. Simply input any ideas collectively on the Digital Whiteboard through embedded virtual stationary kit to make meetings more interesting and understandable than ever before.

Intelligent Gesture Recognition

Conduct simple gestures to freely navigate and illustrate your ideas on Digital Whiteboard.



Drag



Erase



Zoom in/out

User Friendly Toolbar



Adjustable Thickness

Multiple Colour Choices

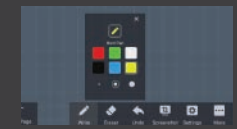



Superior Quality Video Conference Experience

Utilize the embedded high-quality camera to conduct real time, face-to-face interaction virtually with multiple parties beyond geographical boundaries.



Camera
800W / 2K



Microphones
6 / 4



Audio pick up distance
8m



Stereo Channel
2.1



Support Zoom, Cloudlink, WebEx, Skype and a wide range of 3rd party corporate video conferencing software.

zoom CloudLink Cisco webex S Skype



Wireless Multi-device Mirroring

Share individual screen onto GRANDHUB wirelessly to embrace all audiences for synchronised information sharing, whether that is from a smartphone, tablet or personal computer.



Split Screen

Wireless Mirroring supports maximum 4 split screens at the same time.

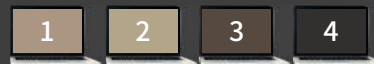

Two-way Interactive Control

User can distantly control GRANDHUB via his/her smartphone or personal computer and vice versa.





Real-time Annotations

User can insert annotations at any given time to highlight key aspects of information shown on GRANDHUB and elaborate accordingly.



POWERPOINT



WORD



EXCEL



PICTURE



VIDEO



Download & Share Instantly

Real time annotations and drawings conducted within Digital Whiteboard can be downloaded or shared instantly as images via QR code, email, or USB flash drive. Review these captures anytime on-the-go.

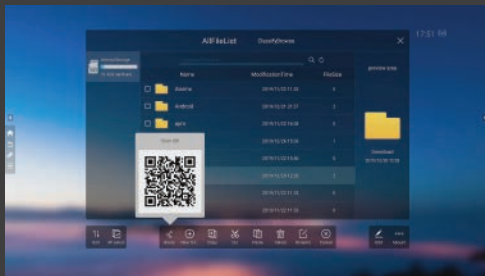

QR Code Scan

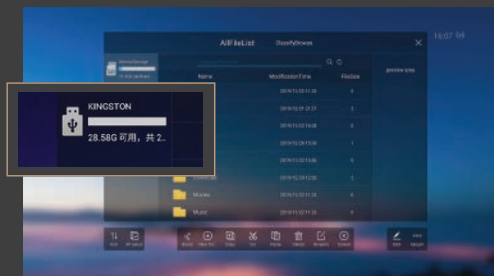

USB Flash Drive

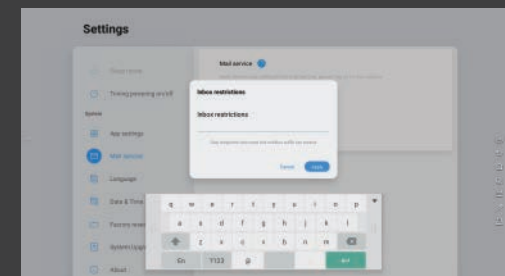

Email

Premium 4K UHD Display

Display of vivid and vibrant color of complex graphics, documents, and video.



178° Ultra Wide Display Angle

Broad angle viewing experience to embrace more audiences.



Anti-Glare Glass Protection

Prevent surface reflection while ensuring the best readability in almost any indoor condition.



Ordinary glass



Anti-glare glass

AG Tempered Glass Mohs Level 7

Interactive panel is guarded by 7H Anti-Glare Tempered Glass, ensuring the top-notch durability.



GRANDHUB | G PRO

The essential entry-level of all-in-one display that is suitable for any settings of use. It is equipped with exceptional 4K display and supports 20 touch points. Embedded with top of line features which help users to optimize the effectiveness of conferences. Instantly transform everyday workplace to an energetic digital collaborative space.

High Performance
Infrared Touch Screen



Max. 20 Touch Points



Built-in 800MP Camera



800W



Dual Operation
System Flexibility
(Android + Windows)



Dual Core Central
Processing Unit



Available in
55", 65", 75", 86" and 98"



Precision of Touch & Smoothness in Writing

Precise infrared touch technology and extraordinary speed in FPS, it provides a fast response yet accurate detection to your movement on screen. Exceptional smoothness and non-delayed pen/hand-writing experience.

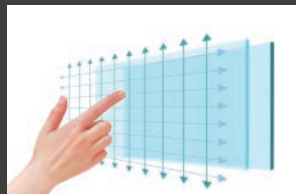

IR emitters and receivers overlaying the inner edges of the display create an invisible grid of IR light beams. Any object interrupting the beams can be accurately identified in the system of coordinates (X & Y) as display is touched.

GRANDHUB | O PRO

Highlighted by its ultra-slim premium design. Featuring One Glass Solution Capacitive Touch Display and phenomenal processing power. Simply flawless. Made for the perfectionist.

Projected
Capacitive Touch



Multi-writing
Digital Whiteboard



Max. 10 Touch Points



Built-in 2K Camera



Dual Operation
System Flexibility
(Android + Windows)



Quad Core Central
Processing Unit



5.8cm Ultra Slim Body



Available in
65", 75", and 86"



PRO



Projected Capacitive Touch Panel

Seamless flat front durable surface, scratch resistant and high endurance. Remarkable sensitivity and an accuracy of 99% in touch detection. Excellent in image clarity.



It is composed of a sheet of glass with embedded conductive materials arrayed in grid format. When a finger makes contact with the screen, it serves as an electrical conductor that denote it as a change of electrical current at the point of touch.



Dual Operating System



Business Analytics

Business analytics utilizes big data, statistical analysis, and data visualization to implement organization changes. Predictive analytics is an important aspect of this work as it involves available data to create statistical models. These models can be used to predict outcomes and inform decision making.



Miracast



Smart Pen



Wireless Microphone



Smart Pen – P300

Offers shortcut buttons for navigation to Digital Whiteboard, Real Time Annotation, and page flipping functionality. A handy tool to conveniently maneuver through a presentation.



Miracast – G200/ G400

Wireless Multi-device Mirroring device for personal computers. Supports up to 4 split screens simultaneously.



Poly Studio Webcam – PSI

UHD 2160p (4K) capture resolution, 120-degree FOV and 5x zoom / EPTZ, upgrade to premium VC experience.



Wireless Microphone – M100-I

360 degree sound reception and echo cancellation.



Open Pluggable Source OPS-I3-I/ OPS-I5-I/ OPS-I7-I

Pluggable PC (Intel Core i3, i5, i7) provides extensive flexibility for users to run different applications within Windows OS.



Mobile Stand Y100-1/ Y200-1/ Y300-1 Y100/Y200/Y300

Heavy duty TV stand with lockable swivel casters for 55" - 98" GRANDHUB.

G PRO Specifications

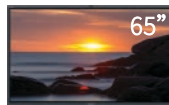
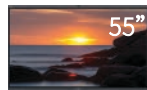

	Model	G055EUH-GPI	G065EUH-GPI	G075EUH-GPI	G086EUH-GPI	G098EUH-GPI
Shell	Frame Material	Aluminium	Aluminium	Aluminium	Aluminium	Aluminium
Display	Size	55"	65"	75"	86"	98"
	Display	D-LED	D-LED	D-LED	D-LED	D-LED
	Resolution	3840 x 2160	3840 x 2160	3840 x 2160	3840 x 2160	3840 x 2160
	Aspect Ratio	16:9	16:9	16:9	16:9	16:9
	Brightness	350 cd/m ²	350 cd/m ²	350 cd/m ²	350 cd/m ²	350 cd/m ²
	Lifetime	> 30,000H	> 30,000H	> 30,000H	> 30,000H	> 30,000H
	Viewing Angle	178°	178°	178°	178°	178°
Glass	Protection Glass Materials	Anti-Glare Glass	Anti-Glare Glass	Anti-Glare Glass	Anti-Glare Glass	Anti-Glare Glass
	Touch Type	Infrared Rays	Infrared Rays	Infrared Rays	Infrared Rays	Infrared Rays
	Multi-touch Point	Max. 20 Points	Max. 20 Points	Max. 20 Points	Max. 20 Points	Max. 20 Points
	Touch Distance Recognized	2mm	2mm	2mm	2mm	2mm
	Touch Accuracy	±1mm (Above 90% of Touch Area)	±1mm (Above 90% of Touch Area)	±1mm (Above 90% of Touch Area)	±1mm (Above 90% of Touch Area)	±1mm (Above 90% of Touch Area)
Operation System	CPU	Dual Core 1.2G	Dual Core 1.2G	Dual Core 1.2G	Dual Core 1.2G	Dual Core 1.2G
	GPU	Mali 450 MP	Mali 450 MP	Mali 450 MP	Mali 450 MP	Mali 450 MP
	RAM	2G	2G	2G	2G	2G
	Internal Storage	32G	32G	32G	32G	32G
	Operation System	Android 7.0	Android 7.0	Android 7.0	Android 7.0	Android 7.0
	On-Screen Display Language	English	English	English	English	English
Audio and Video	Speaker	2 x 10w (Treble) + 15w (Base)	2 x 10w (Treble) + 15w (Base)	2 x 10w (Treble) + 15w (Base)	2 x 10w (Treble) + 15w (Base)	2 x 10w (Treble) + 15w (Base)
	Camera	800MP / 73° FoV	800MP / 73° FoV	800MP / 73° FoV	800MP / 73° FoV	800MP / 73° FoV
	Microphone	6 units of Microphone/ pick up sound sources up to 8m	6 units of Microphone/ pick up sound sources up to 8m	6 units of Microphone/ pick up sound sources up to 8m	6 units of Microphone/ pick up sound sources up to 8m	6 units of Microphone/ pick up sound sources up to 8m
Power	Power Supply	100-240V/ 50-60HZ	100-240V/ 50-60HZ	100-240V/ 50-60HZ	100-240V/ 50-60HZ	100-240V/ 50-60HZ
	Power Consumption	200W	250W	300W	500W	750W
Physical Specification	Weight (Display / Shipping)	26KG / 36KG	37.5KG / 49.8KG	52.3KG / 66.2 KG	69.8KG / 89.4KG	102KG / 136KG
	Device Dimension(W x H x D) (Display / Carton)	1262 x 782 x 85 mm / 1428 x 878 x 220 mm	1489 x 906 x 89 mm / 1656 x 1050 x 204 mm	1710 x 1029 x 89 mm / 1886 x 1196 x 210 mm	1957 x 1169 x 90 mm / 2134 x 1334 x 210 mm	2244 x 1323.2 x 89.5 mm / 2483 x 1493 x 376 mm
Accessories (Optional)	Miracast, Smart Pen, OPS Intel Core i3, i5, i7, Mobile Stand, Poly Studio Webcam, Wireless Microphone					

O PRO Specifications



	Model	G065EUH-OPI	G075EUH-OPI	G086EUH-OPI
Shell	Frame Material	Aluminium	Aluminium	Aluminium
Display Panel	Size	65"	75"	86"
	Display	D-LED	D-LED	D-LED
	Resolution	3840 x 2160	3840 x 2160	3840 x 2160
	Aspect Ratio	16:9	16:9	16:9
	Contrast Ratio	4000:1	4000:1	4000:1
	Brightness	350 cd/m ²	350 cd/m ²	350 cd/m ²
	Viewing Angle	178°	178°	178°
Glass	Protection Glass Materials	Anti-Glare Glass	Anti-Glare Glass	Anti-Glare Glass
	Touch Type	Projected Capacitive Touch	Projected Capacitive Touch	Projected Capacitive Touch
	Touch Panel	OGS	OGS	OGS
	Multi-touch Point	Max. 10 Points	Max. 10 Points	Max. 10 Points
Operation System	CPU	Cortex A73*2+A53*2 Quad-core 1.5GHz	Cortex A73*2+A53*2 Quad-core 1.5GHz	Cortex A73*2+A53*2 Quad-core 1.5GHz
	GPU	Quad-core MaliG51	Quad-core MaliG51	Quad-core MaliG51
	RAM	3G	3G	3G
	Internal Storage	16G	16G	16G
	Operation System	Android 8.0	Android 8.0	Android 8.0
	On-Screen Display Language	English	English	English
Audio and Video	Camera	2K	2K	2K
	Microphone	4 units of Microphone	4 units of Microphone	4 units of Microphone
Power	Power Supply	100-240V / 50-60HZ	100-240V / 50-60HZ	100-240V / 50-60HZ
	Power Consumption	350W	400W	500W
Physical Specification	Weight (Display / Shipping)	45KG / 58KG	62KG / 75KG	78KG / 92KG
	Device Dimension(W x H x D) (Display / Carton)	1507.54 x 929.19 x 93.07 mm / 1640 x 1035 x 221 mm	1729.87 x 1053.09 x 94.27 mm / 1859 x 1167 x 237 mm	1975.64 x 1192.96 x 94.27 mm / 2119 x 1309 x 275 mm
Accessories	Miracast, OPS Intel Core i3, i5, i7, Mobile Stand, Poly Studio Webcam, Wireless Microphone			



Grandwon International Limited

Unit 16, 22/F, Technology Park, 18 On Lai Street, Shatin, Hong Kong

Email : globalsales@grandwon.com Web : www.grandwon.com

Tel : (852) 3972 0188 Fax : (852) 3905 9226

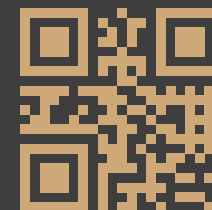

Continuous upgrade of products, the actual product shall always prevail in case of any discrepancies

Copyright © Grandwon International Limited